

# Session Planner

Date: \_\_\_\_\_

Project: \_\_\_\_\_ Recording Format: \_\_\_\_\_

Engineer: \_\_\_\_\_ Assist: \_\_\_\_\_



Source	Mic	Preamp	Processor	Console#	Buss/Dir	Track#	Studio Equipment Available
							DDA AMR-24 Console 32x24x24
							Digidesign Pro-Tools HD
							3-192 convertors 32x24
							OtariMTR 90II 24-track
							Alesis Masterlink
							5 AKG 414
							AKG "The Tube"
							2 Audio Technica 4033
							2-Audio Technica 4050
							Neumann KM-84
							Neumann Fet 47
							2 Neumann U-67
							3 Neumann U-87
							1 Lawson L47 Updated '09
							6 Sennheiser 421
							AKG D112
							Shure Beta 52
							2 Shure SM-7
							5 Shure SM 57
							4 Shure SM-81
							2 Crown PZM
							2 EV 308
							2 EV RE 20
							RCA 77Dx
							4 AKG C-451E
							EV 868
							2 Shure KSM44/SL
							2 Avalon VT737sp
							Vintech 473
							2 AMEK 9098
							Buzz MA-2
							2 SummittTLA -100
							Teletronix LA-2A
							Tubetech CL-1A
							2 UREI 1176
							3 UREI LA-3
							Lexicon M480L
							Lexicon PCM-42
							Yamaha SPX-90II
							4 DBX 160
							DBX 160X

Notes:

Date: \_\_\_\_\_

Client: \_\_\_\_\_

Producer: \_\_\_\_\_

Engineer: \_\_\_\_\_

Assist: \_\_\_\_\_

Format: \_\_\_\_\_

Notes:

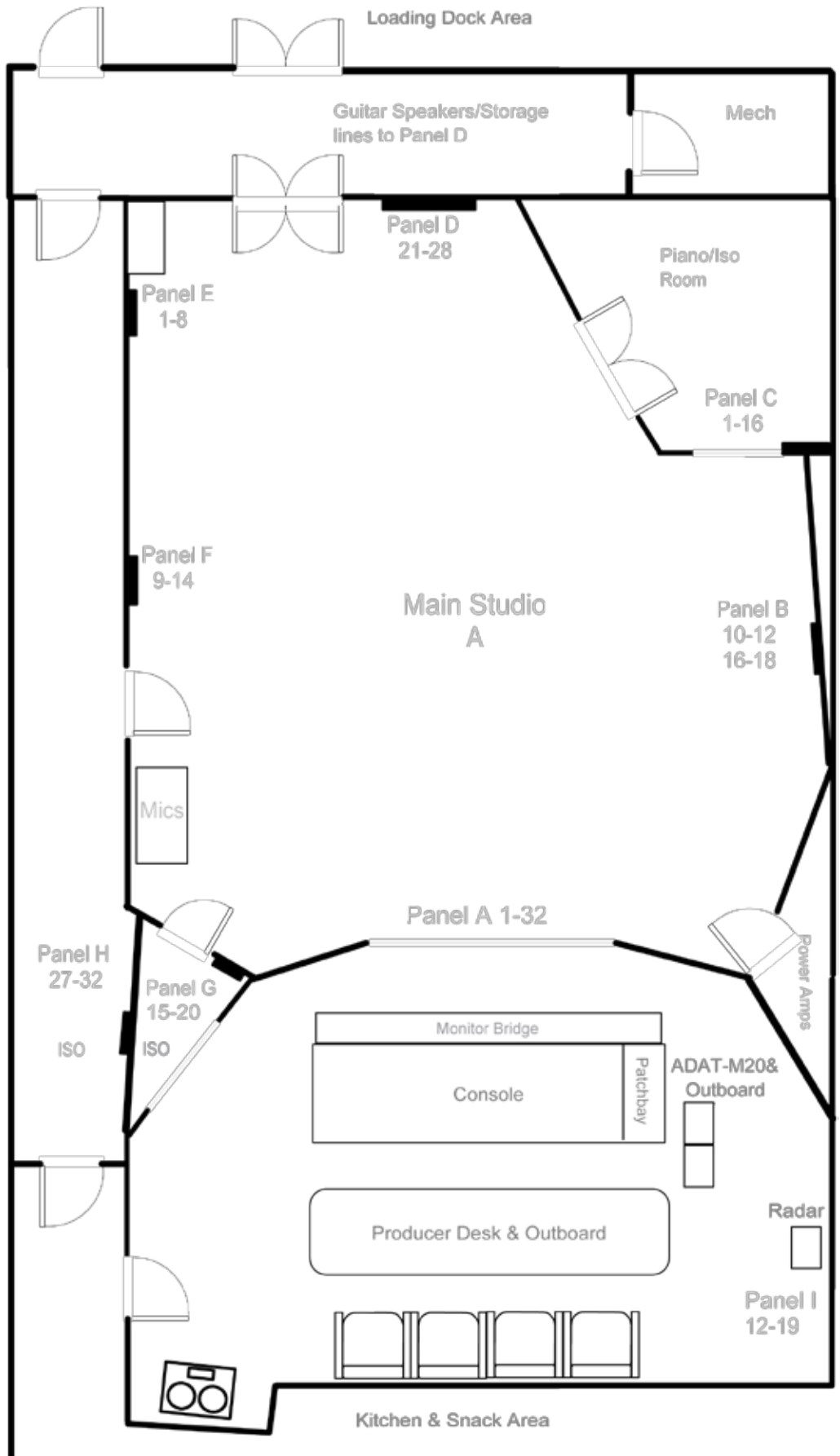

### Classic Recording Studio A Session Layout